



# TAMAN BENTARA

SINGLE & DOUBLE STOREY TERRACE HOUSE



For illustration purpose only / Artist impression only



**MOSCON GROUP**

**KINRAYA DEVELOPMENT SDN BHD** (786735-A)

No. 34, 34-1 & 34-2, Jalan Jasmin 6/KS6, Bandar Botanic, 41200 Klang, Selangor Darul Ehsan.

• Developer: Kinraya Development Sdn Bhd (786735-A) • Address: No. 34, Jalan Jasmin 6/KS6, Bandar Botanic, 41200 Klang, Selangor • Type: Residential • Developer's License: DL: 11376/06-2027/0820(R) • Validity Period: 16/06/2022- 15/06/2027 • Advertising Permit: 11376-5/12-2025/1369(N)-(L) • Validity Period: 28/12/2023 to 27/12/2025 • Building Plan Approval No: MPKL/JKB/1/4/20/2022(18) • Approval Authority: Majlis Perbandaran Kuala Langat • Tenure: Leasehold • Encumbrances: None • Expected Date of Completion: 5/2026 • Total Units: 23

Disclaimer: All renderings contained herein are artist impressions only. The information contained herein is subject to change without notification as may be required by the relevant authorities or developer's project consultant. Whilst every care is taken in providing this information, the owner, developers and managers cannot be held responsible for any variations. For avoidance doubt on the specifications, please always refer to the sale and purchase agreement. Terms and conditions apply.

JALAN BALAM 4/40

JALAN BALAM 4/40

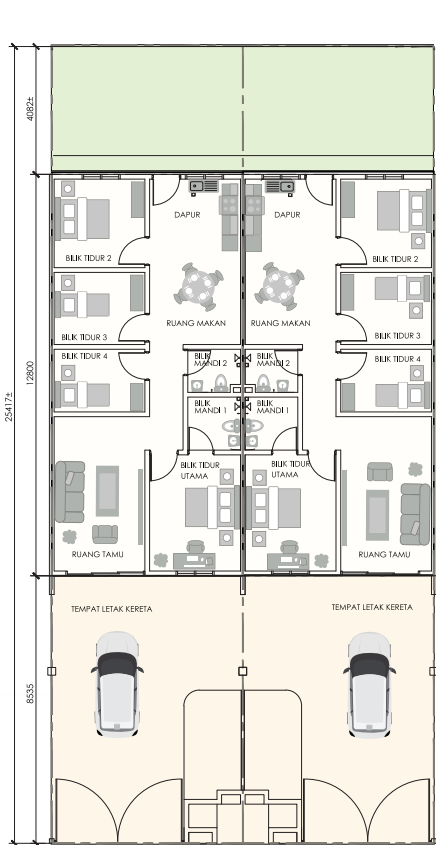
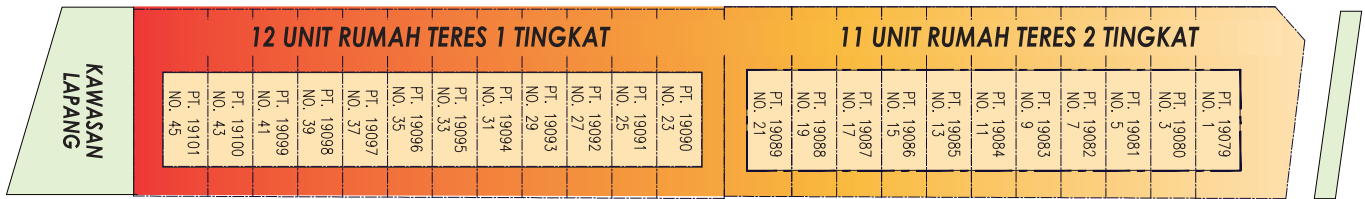

**INTERMEDIATE A**  
(SINGLE STOREY)

Land size  
20' X 83'

Build-up  
1040 SQFT

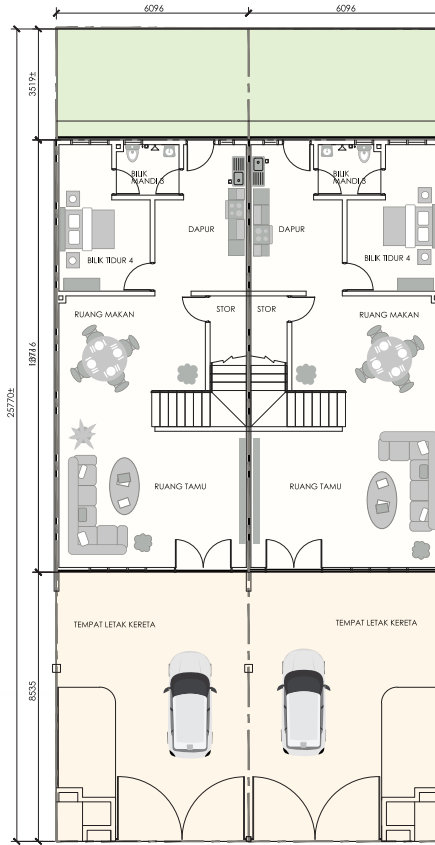

**INTERMEDIATE B**  
(DOUBLE STOREY)

Land size  
20' X 85'

Build-up  
2000 SQFT

